

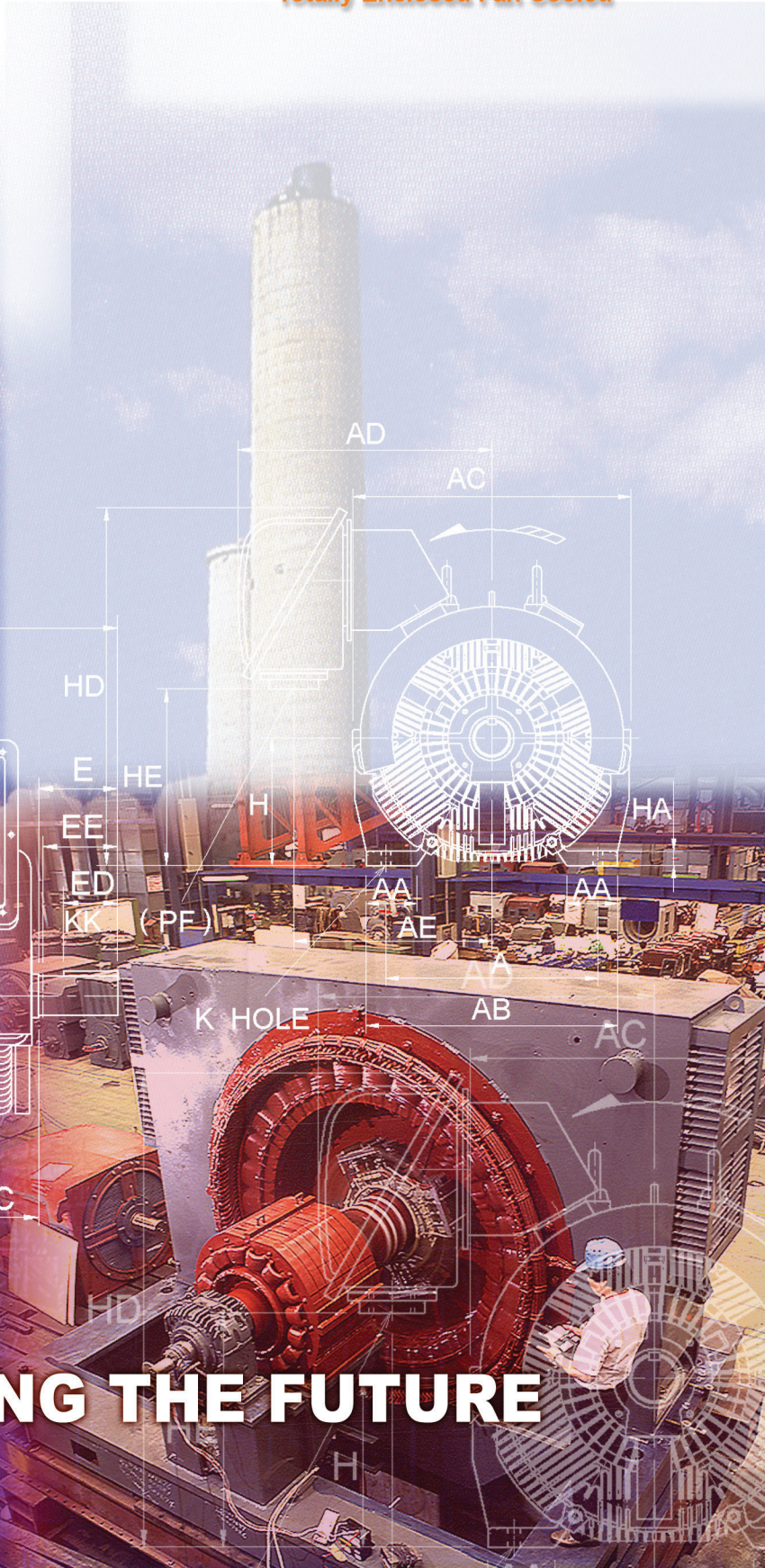

# New Global SERIES

Totally Enclosed Fan Cooled



**ENGINEERING THE FUTURE**



# NEW GLOBAL SERIES

## FEATURES:

### ◆ Frame size reduction

Reduce the frame size and improve the efficiency at the same time to meet the market demand.

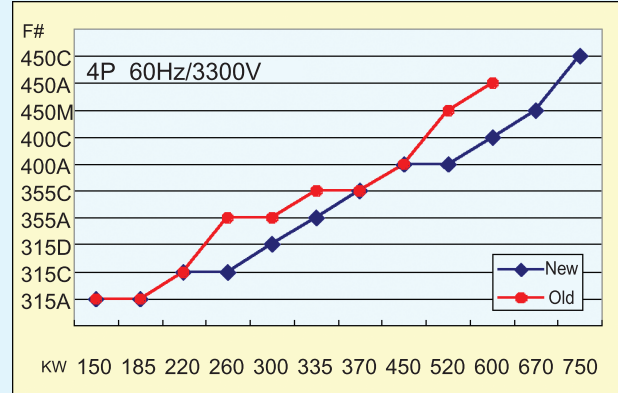
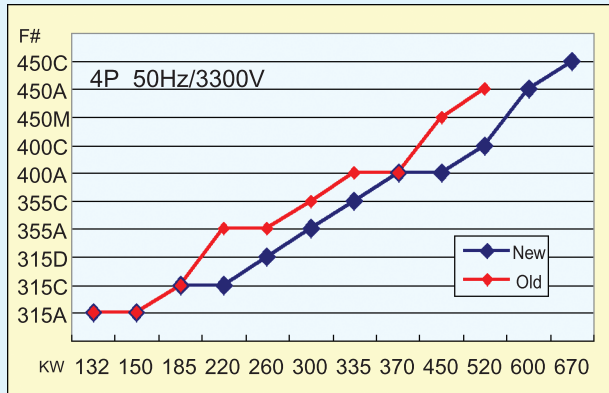

### ◆ Premium efficiency

The efficiency level have been substantially improved for greater savings.

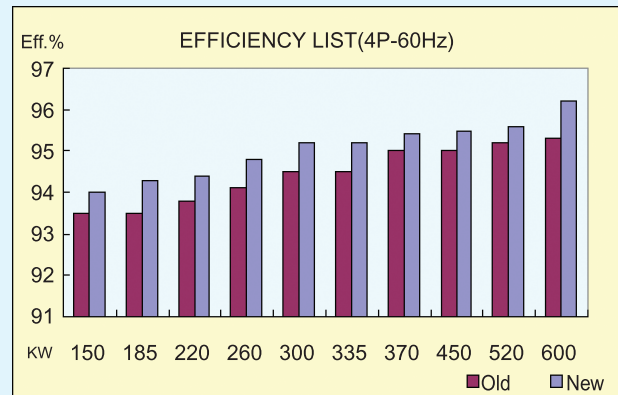
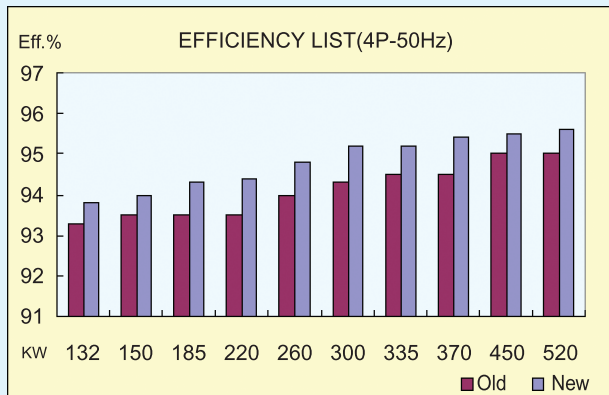

### ◆ Low noise

Reduce the noise level 4~9dBA compared to traditional standard motors.  
(The noise level is based on test at no-load and 1 M distance)

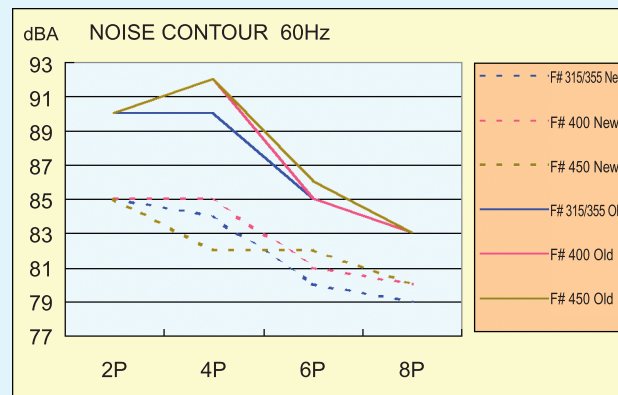
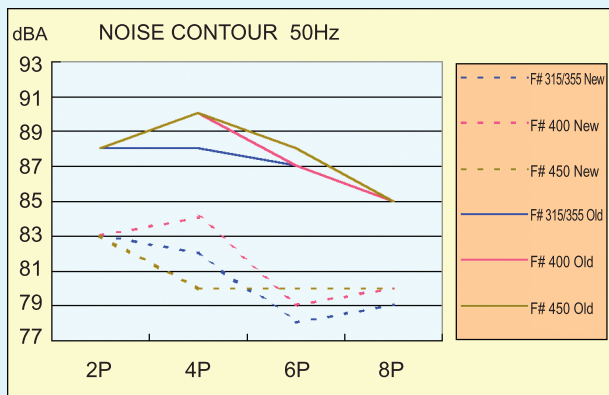

# BASIC SPECIFICATIONS

	ITEM	STANDARD SPECIFICATION	
RATING	KIND OF MOTOR	SQUIRREL-CAGE INDUCTION MOTOR (SCIM)	
	DESIGN STANDARD	IEC 34 , BS 4999 , BS 5000 , CNS	
	VOLTAGE	MEDIUM VOLTAGE: 2300V, 3000V, 3300V, 4160V, 6000V, 6600V LOW VOLTAGE: 60Hz: 380V, 440V, 460V 50Hz: 380V, 415V	
	FREQUENCY	50Hz OR 60Hz	
	OUTPUT RANGE	MEDIUM VOLTAGE: 125HP ~ 2000HP ( 90kw ~ 1500kw ) LOW VOLTAGE: 150HP ~ 900HP ( 110kw ~ 670kw )	
	R.P.M. (SYN.)	60Hz: 3600 ~ 900 R.P.M.( 2 ~ 8 POLE) 50Hz: 3000 ~ 750 R.P.M.( 2 ~ 8 POLE)	
	TIME DUTY	CONTINUOUS S.F. 1.0 (S1, MCR)	
	FRAME NO.	315A ~ 560C (MEDIUM VOLTAGE). 315A ~ 450A (LOW VOLTAGE).	
	PROTECTION ENCLOSURE	TOTALLY ENCLOSED ( IP 54 )	
	COOLING METHOD	SELF EXTERNAL FAN,SURFACE COOLING(IC 411)	
	MOUNTING	HORIZONTAL FOOT MOUNTING ( IM 1001,B3 )	
APPLICATION	AMBIENT CONDITION	PLACE	SHADOW, NON-HAZARDOUS
		TEMPERATURE	-20°C ~ 40°C
		HUMIDITY	RELATIVE HUMIDITY:LESS THAN 95% RH (NON-CONDENSATION)
		ALTITUDE	LESS THAN 1000 METERS
	DRIVE METHOD	DIRECT COUPLING	
	DIRECTION OF ROTATION	BI-DIRECTIONAL, EXCEPT 2 POLE WHICH IS COUNTER-CLOCKWISE FACING THE DRIVE END	
	METHOD OF STARTING	MEDIUM VOLTAGE: DIRECT-ON LINE(D.O.L.), OR REDUCED- VOLTAGE STARTING LOW VOLTAGE: D.O.L. OR STAR-DELTA OR REDUCED-VOLTAGE STARTING	
CONSTRUCTION	BEARING	BRACKET MOUNTING, VACUUM DE-GASSED HIGH QUALITY ROLLING BEARING WITH REGREASE PROVISIONS	
	TERMINAL BOX	CAST IRON, LARGE SIZE, CAN BE ROTATED EACH 90° STEP, WITH CONDUIT HOLE COVERED WITH PLATE FOR CABLE ENTRANCE, AT LEFT HAND SIDE FACING DRIVE END IS STANDARD	
	LEAD TERMINAL	MEDIUM VOLTAGE: 3 OR 6 LEADS, WITH SOLDERLESS LUG TERMINALS LOW VOLTAGE: 6 LEADS, WITH SOLDERLESS LUG TERMINALS	
	STATOR INSULATION	CLASS F INSULATION SYSTEM	
	PAINTING	MODIFIED PHENOL RESIN WITH IRON OXIDE RUST PROOF BASE, PLUS ALKYD SURFACE FINISH PAINTING IN BLUE-GRAY COLOR (MUNSELL 7.5B 3.5/0.5)	
	BOLT THREAD	ISO METRIC SYSTEM	
PERFORMANCE	TEST PROCEDURE	IEC 34, BS 4999, AS1359	
	TEMPERATURE RISE	NOT TO EXCEED 80°C BY RESISTANCE METHOD	
	OVER SPEED	120% SYN. R.P.M. FOR TWO MIN.	
	OVER TORQUE	160% RATED TORQUE FOR 15 SEC.	

# TEFC - MEDIUM VOLTAGE

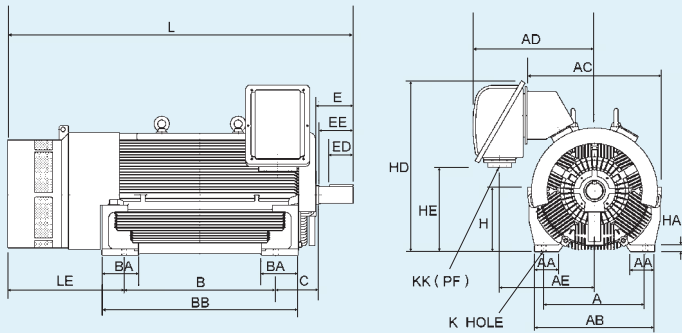

FIG.1

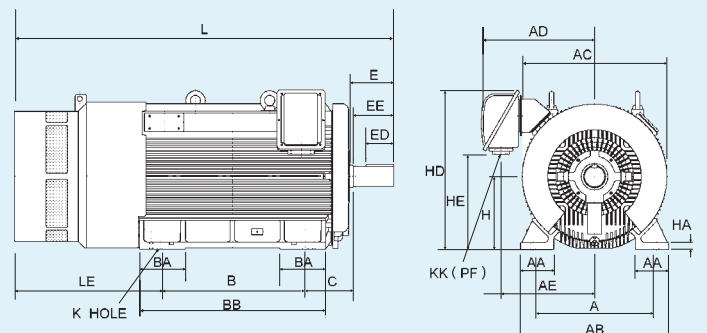
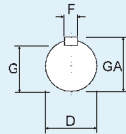

FIG.3

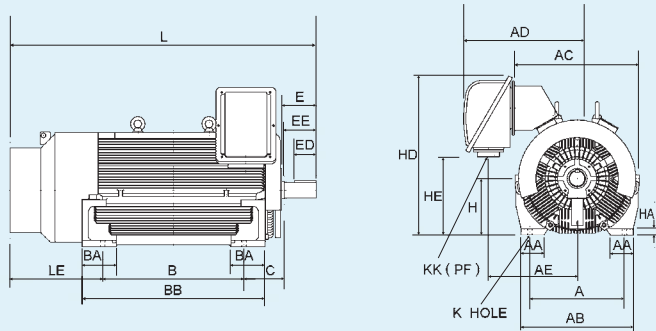
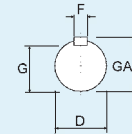

FIG.2

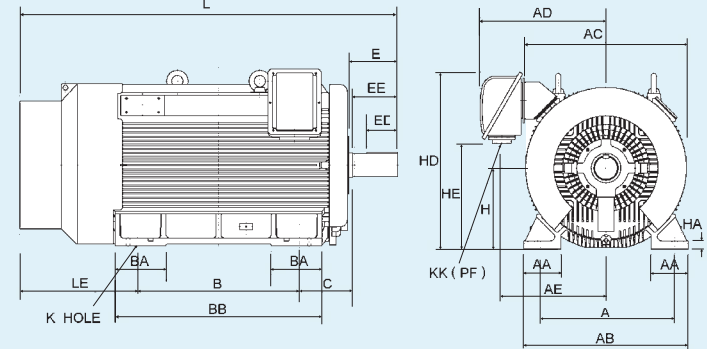
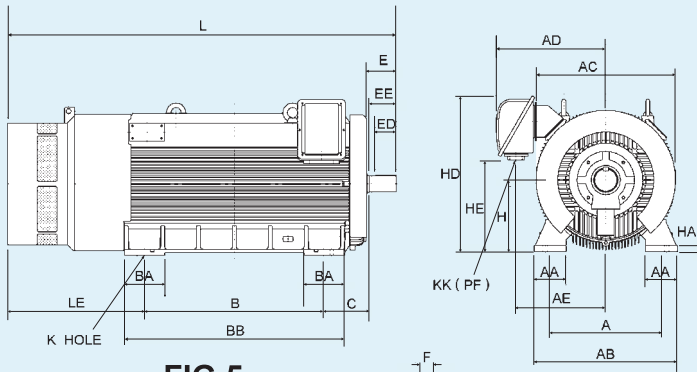

FIG.4

Frame No.	No. of Poles	Fig.	Mounting								AC	AD	AE	H	HA	HD
			A	AA	AB	B	BA	BB	C	K						
315A	2P	1	508	150	650	560	180	730	216	28	730	666	511	315	45	874
315A	4P	2	508	150	650	560	180	730	216	28	730	666	511	315	45	874
315A	6P&8P	2	508	150	650	560	180	730	216	28	730	666	511	315	45	874
315C	2P	1	508	150	650	710	180	880	216	28	730	666	511	315	45	874
315C	4P	2	508	150	650	710	180	880	216	28	730	666	511	315	45	874
315C	6P&8P	2	508	150	650	710	180	880	216	28	730	666	511	315	45	874
315D	2P	1	508	150	650	910	180	1080	216	28	730	666	511	315	45	874
315D	4P	2	508	150	650	910	180	1080	216	28	730	666	511	315	45	874
315D	6P&8P	2	508	150	650	910	180	1080	216	28	730	666	511	315	45	874
355A	4P	2	610	150	750	710	210	930	254	28	810	762	607	355	45	997
355A	6P&8P	2	610	150	750	710	210	930	254	28	810	762	607	355	45	997
355C	2P	1	610	150	750	900	210	1120	254	28	810	762	607	355	45	997
355C	4P	2	610	150	750	900	210	1120	254	28	810	762	607	355	45	997
355C	6P&8P	2	610	150	750	900	210	1120	254	28	810	762	607	355	45	997
400A	4P	2	686	150	810	800	245	1060	280	35	860	774	619	400	40	1062
400A	6P&8P	2	686	150	810	800	245	1060	280	35	860	774	619	400	40	1062
400C	2P	1	686	150	810	1000	245	1260	280	35	860	774	619	400	40	1062
400C	4P	2	686	150	810	1000	245	1260	280	35	860	774	619	400	40	1062
400C	6P&8P	2	686	150	810	1000	245	1260	280	35	860	774	619	400	40	1062
450A	4P	1	750	180	890	900	270	1230	315	35	986	807	652	450	50	1170
450A	6P&8P	2	750	180	890	900	270	1230	315	35	986	807	652	450	50	1170
450C	2P	1	750	180	890	1120	270	1450	315	35	986	807	652	450	50	1170
450C	4P	1	750	180	890	1120	270	1450	315	35	986	807	652	450	50	1170
450C	6P&8P	2	750	180	890	1120	270	1450	315	35	986	807	652	450	50	1170
500C	4P	3	850	230	1020	1250	315	1530	335	35	996	822	667	500	50	1123
500C	6P&8P	4	850	230	1020	1250	315	1530	335	35	996	822	667	500	50	1123
560C	4P	5	950	250	1120	1400	315	1720	355	42	1090	857	702	560	50	1218
560C	6P&8P	6	950	250	1120	1400	315	1720	355	42	1090	857	702	560	50	1218

Dimensions in mm



**FIG.5**

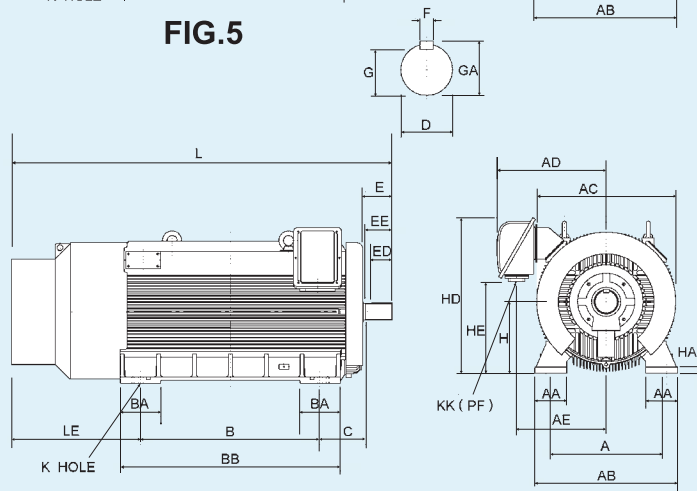

**FIG.6**

**NOTES**

1. Tolerance of shaft extension diameter  $D = m6$
2. Tolerance of shaft center height  $H = +0, -1$
3. For direct flexible coupling
4. Usable shaft length: EE

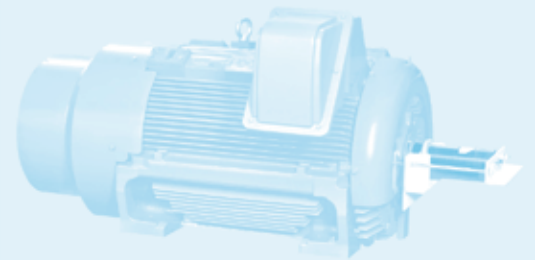

HE	KK	L	LE	Shaft Extension				Key Size			Bearing		Frame No.
				D	E	EE	G	ED	F	GA	DRIVE END	OPP DRIVE END	
470	4"	1516	600	70	140	134	62.5	110	20	74.5	6315C3	6315C3	315A
470	4"	1496	550	95	170	157	86	140	25	100	6320	6320	315A
470	4"	1456	510	95	170	157	86	140	25	100	6320	6320	315A
470	4"	1666	600	70	140	134	62.5	110	20	74.5	6315C3	6315C3	315C
470	4"	1646	550	95	170	157	86	110	25	100	6320	6320	315C
470	4"	1606	510	95	170	157	86	140	25	100	6320	6320	315C
470	4"	1866	600	70	140	134	62.5	110	20	74.5	6315C3	6315C3	315D
470	4"	1846	550	95	170	157	86	140	25	100	6320	6320	315D
470	4"	1806	510	95	170	157	86	140	25	100	6320	6320	315D
497	5"	1749	615	95	170	157	86	140	25	100	6322	6320	355A
497	5"	1749	615	95	170	157	86	140	25	100	6322	6320	355A
497	5"	1939	645	70	140	134	62.5	110	20	74.5	6315C3	6315C3	355C
497	5"	1939	615	95	170	157	86	140	25	100	6322	6320	355C
497	5"	1939	615	95	170	157	86	140	25	100	6322	6320	355C
562	5"	1925	635	110	210	197	100	160	28	116	6324	6320	400A
562	5"	1925	635	110	210	197	100	160	28	116	6324	6320	400A
562	5"	2145	725	70	140	134	62.5	110	20	74.5	6315C3	6315C3	400C
562	5"	2125	635	110	210	197	100	160	28	116	6324	6320	400C
562	5"	2125	635	110	210	197	100	160	28	116	6324	6320	400C
670	5"	2205	780	110	210	197	100	160	28	116	6324	6322	450A
670	5"	2135	710	110	210	197	100	160	28	116	6324	6322	450A
670	5"	2335	760	70	140	134	62.5	110	20	74.5	6315C3	6315C3	450C
670	5"	2425	780	110	210	197	100	160	28	116	6324	6322	450C
670	5"	2355	710	110	210	197	100	160	28	116	6324	6322	450C
623	5"	2610	815	125	210	197	114	160	32	132	6326	6324M/C3,VLO24	500C
623	5"	2560	765	125	210	197	114	160	32	132	6326	6324M/C3,VLO24	500C
718	5"	2885	880	140	250	237	128	200	36	148	6330	6326M/C3,VLO24	560C
718	5"	2855	850	140	250	237	128	200	36	148	6330	6326M/C3,VLO24	560C

# TEFC - LOW VOLTAGE

FIG.1

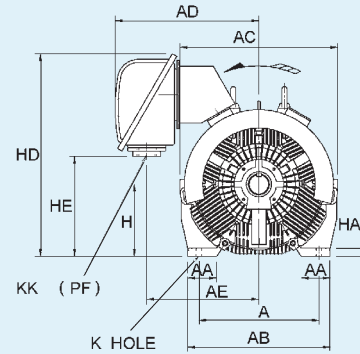
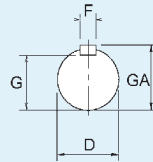
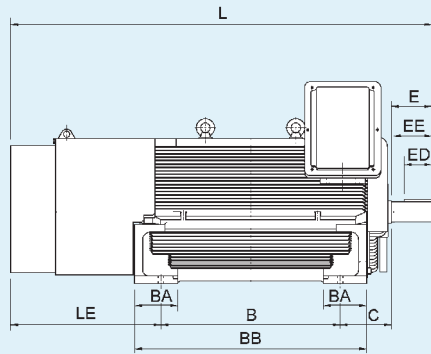
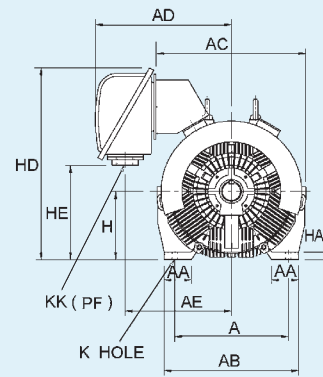
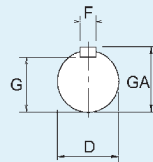
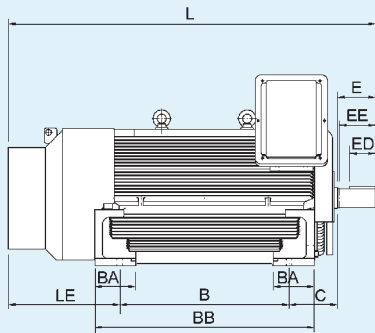

FIG.2



Frame No.	No. of Poles	Fig.	Mounting								AC	AD	AE	H	HA	HD
			A	AA	AB	B	BA	BB	C	K						
315A	2P	1	508	150	650	560	180	730	216	28	730	666	511	315	45	874
315A	4P/6P/8P	2	508	150	650	560	180	730	216	28	730	666	511	315	45	874
315C	2P	1	508	150	650	710	180	880	216	28	730	666	511	315	45	874
315C	4P/6P/8P	2	508	150	650	710	180	880	216	28	730	666	511	315	45	874
315D	2P	1	508	150	650	910	180	1080	216	28	730	666	511	315	45	874
315D	4P/6P/8P	2	508	150	650	910	180	1080	216	28	730	666	511	315	45	874
355A	2P	1	610	150	750	710	210	930	254	28	810	762	607	355	45	997
355A	4P/6P/8P	2	610	150	750	710	210	930	254	28	810	762	607	355	45	997
355C	4P/6P/8P	2	610	150	750	900	210	1120	254	28	810	762	607	355	45	997
400A	4P/6P/8P	2	686	150	810	800	245	1060	280	35	860	774	619	400	40	1062
400C	2P	1	686	150	810	1000	245	1260	280	35	860	774	619	400	40	1062
400C	4P/6P/8P	2	686	150	810	1000	245	1260	280	35	860	774	619	400	40	1062
450A	2P	1	750	180	890	900	270	1230	315	35	986	807	652	450	50	1170
450A	4P	3	750	180	890	900	270	1230	315	35	986	807	652	450	50	1170
450A	6P/8P	2	750	180	890	900	270	1230	315	35	986	807	652	450	50	1170

Dimensions in mm

**FIG.3**

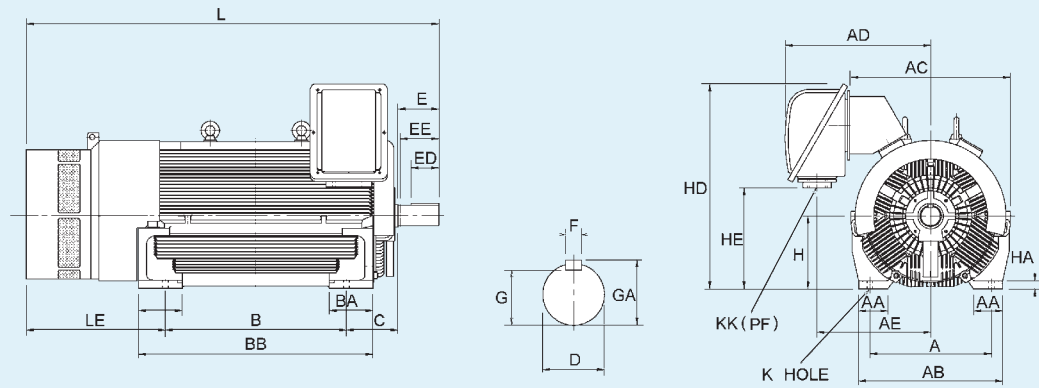

**NOTES**

1. Tolerance of shaft extension diameter  $D = m6$
2. Tolerance of shaft center height  $H = +0, -1$
3. For direct flexible coupling
4. Usable shaft length: EE

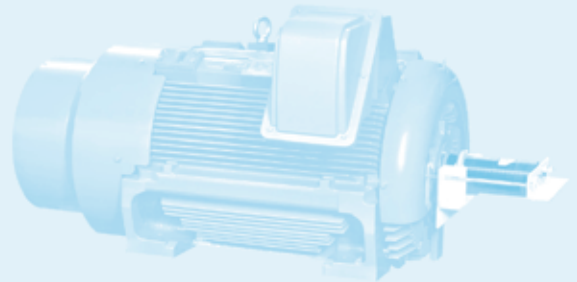

HE	KK	L	LE	Shaft Extension				Key Size			Bearing		Frame No.
				D	E	EE	G	ED	F	GA	DRIVE END	OPP DRIVE END	
469	4"	1601	685	70	140	134	62.5	110	20	74.5	6315C3	6315C3	315A
469	4"	1496	550	95	170	157	86	140	25	100	6320	6320	315A
469	4"	1751	685	70	140	134	62.5	110	20	74.5	6315C3	6315C3	315C
469	4"	1646	550	95	170	157	86	140	25	100	6320	6320	315C
469	4"	1951	685	70	140	134	62.5	110	20	74.5	6315C3	6315C3	315D
469	4"	1846	550	95	170	157	86	140	25	100	6320	6320	315D
504	5"	1854	750	70	140	134	62.5	110	25	74.5	6315C3	6315C3	355A
504	5"	1749	615	95	170	157	86	140	25	100	6322	6320	355A
504	5"	1939	615	95	170	157	86	140	25	100	6322	6320	355C
569	5"	1925	635	110	210	197	100	160	28	116	6324	6320	400A
569	5"	2200	780	70	140	134	62.5	110	20	74.5	6315C3	6315C3	400C
569	5"	2125	635	110	210	197	100	160	28	116	6324	6320	400C
677	5"	2240	885	70	140	134	62.5	110	20	74.5	6315C3	6315C3	450A
677	5"	2205	780	110	210	197	100	160	28	116	6324	6322	450A
677	5"	2135	710	110	210	197	100	160	28	116	6324	6322	450A



## HEAD OFFICE

TECO Electric & Machinery Co., Ltd  
1 OF No,3-1, Yuan Cyu st.  
Nan-kang Taipei 115  
Taiwan ROC  
TEL: +886 2 6615 9111  
www.teco.com.tw/fa

## UNITED STATES

TECO Westinghouse Motor Company  
5100 N IH-35  
Round Rock Texas 78681 USA  
Tel: +1 512 225 4141  
+1 800 451 8798  
Fax: +1 512 244 5512  
Toll Free: +1 800 451 8798  
www.tecowestinghouse.com

## CANADA

TECO-Westinghouse Motors Inc. (Canada)  
18060-109 Avenue, Edmonton, Alberta  
T5S 2K2 Canada  
Tel: +1 (780) 444 8933  
Fax: +1 (780) 486 4575  
24 HR Emergency ph:  
+1 (780) 994 8964  
Toll Free: +1 800 661 4023  
Fax Toll Free: +1 888 USE TWMI  
E-mail: webm@twmi.com  
www.twmi.com

## MEXICO

TECO Westinghouse Motor Company  
S.A. de C.V.  
Circuito Mexiamora Poniente No. 321  
Col. Puerto Interior,  
Parque Santa Fe CP 36275  
Silao, Guanajuato, México  
Tel: +52 (472) 748 9016 al 20  
E-mail: ventas@tecowestinghouse.com

## NETHERLANDS

Teco Electric & Machinery B.V.  
Rivium 3e Straat 17  
2909 LH Capelle a/d IJssel  
The Netherlands  
Tel: +31 (0)10 266 6633  
Fax: +31 (0) 10 202 6415  
E-mail:enquiries@teco-group.eu  
www.teco-group.eu

## UNITED KINGDOM

TECO ELECTRIC EUROPE LTD  
7 Dakota Avenue, Salford M50 2PU  
United Kingdom  
Tel: +44 161 877 8025  
Fax: +44 161 877 8030  
www.teco-group.eu

## GERMANY

TECO Electric and Machinery GmbH  
Poststrasse 6  
37441 Bad Sachsa, Germany  
Tel: +49 (0) 5523 95340  
Fax: +49 (0) 5523 9534 24  
E-mail: postmaster@teco-westinghouse.de  
www.teco-group.eu

## SPAIN

C/Apostol Santiago, 38, 1 -1,  
28017 Madrid  
Spain  
Tel: +34 91 326 30 91  
Fax: +34 91 326 30 91  
www.teco-group.eu

## MIDDLE EAST

Teco Middle East Electric & Machinery Co., Ltd.  
2nd Industrial City, Dammam  
PO Box #708, Dammam 31421  
Kingdom of Saudi Arabia  
Tel: +966 3 812 3939  
Fax: +966 3 812 4823  
Email: sales@teco-me.com

## SAUDI ARABIA

Al Quraishi Electrical Services of S.A.  
Al Quraishi Center, King Khalid Street,  
P.O.Box 7386, Dammam-31462  
Tel: +966 3 857-2537  
Fax: +966 3 857-2541  
Email : dannya@aqesa.com  
www.aqesa.com

## IRAN, AZERBAIJAN & ARMENIA

ATLAS DIBA Engineering & Trade Co.  
No.3, Fakouri St., South Kadj Ave.  
Golha Sq., Fatemi, Tehran, Iran  
Tel: +98 21 88 33 03 81-3  
Fax: +98 21 88 33 03 84  
Email : info@atlasdibaco.com  
www.atlasdibaco.com

## EGYPT

Amosl & Co.  
38 Mossadak Street Dokki, Giza, Egypt  
Tel: +202 333 79 744  
Fax: +202 376 20 307

## TUNISIA and ALGERIA

AFRICA COMPANY  
Route de Tunis km 1,  
rue Hassan hosni Abdelwaheb - Imm Dammak,  
Mezzanine Sfax 3002 - Tunisia  
Tel: +216-74436585, +216-74436585  
Fax: +216-74436587

## TURKEY

TECO Elektrik Turkey A.S.  
Yesilkoy Mah. Atatürk Caddesi No:12/1  
EGS Business Park; B1 Blok 3. Kat; Daire No: 173-174  
34149 - Bakirkoy/ Istanbul TURKEY  
Phone: +90 212 465 4540  
Fax: +90 212 465 4599  
Mobile : +90 553 461 4848

## SOUTH AFRICA

TECO Electric & Machinery Co. Ltd  
E-mail: manish@teco.com.tw

## AUSTRALIA

Teco Australia Pty Ltd.  
335-337 Woodpark Road  
Smithfield NSW 2164 Australia  
Tel: +61 2 9765 8118  
Fax: 61-2-9604-9330  
E-mail: emd@teco.com.au  
www.teco.com.au

## NEW ZEALAND

Teco New Zealand Pty Ltd.  
Unit 3, 477 Great South Road  
Penrose Auckland New Zealand  
Tel: +64 9 526 8480  
Fax: 64 9-526-8484  
E-mail: philr@teco.co.nz

## JAPAN

Sankyo Co., Ltd.  
26th fl. World Trading Center Bldg.  
2-4-1 Hamamatsucho Minato-ku  
Tokyo Japan 105-6126  
Tel: +81 3 3435 9729  
Fax: +81 3 3578 8381  
E-mail: s.mabuchi@teco-japan.com  
Website:www.teco-japan.com

## SINGAPORE

Teco Electric & Machinery(PTE)Ltd.  
18 chin Bee Drive  
Singapore 619865  
Tel: +65 6 265 4622  
E-mail: ds@teco.com.sg  
www.teco.com.sg

## INDONESIA

P.T. Teco Multiguna Elektro  
JL Bandengan Utara No. 83/1-2-3  
Jakarta Utara-14140 Indonesia  
Tel: +62 21 662 2201  
Fax: 62-21-6697029

## INDIA

TECO Electric & Machinery Co., Ltd.  
New Delhi Office  
Phone: 91-11-22314654  
Mobile: 91-9873390999  
Contact: Vijay Sankar  
E-mail: vijay@teco.com.sg

## CHINA

Shanghai Office  
Rm 321 Building No.6  
Lane 1279 Zhongshan W. Rd.  
Shanghai, P.R.C  
Tel: +86 21 5116 8255  
Fax: +86 21 6278 8761

Wuxi Teco Electric & Machinery Co., Ltd  
No. 9 South of Changjiang Road,  
New Zone, Wuxi  
Jiangsu Province, P.R.C.  
Tel: +86 510 8534 2005  
Fax: +86 510 8534 2001  
www.wuxiteco.com

Jiangxi Teco Electric & Machinery Co., Ltd  
189 Dongyuan Rd. Hi-Tech Zone, Nanchang  
Jiangxi Province, P.R.C.  
Tel: +86 791 819 5999  
Fax: +86 791 816 7730

SUZHOU TECO Electric & Machinery Co., Ltd  
No.1 Changjiang W.Rd.  
South-Dam Industrial Park,  
Liuhe Town, Taicang City,  
Suzhou, Jiangsu Province, P.R.C.  
Tel: +86 512 5361 9901  
Fax: +86 512 5396 1058

FUJIAN TECO PRECISION CO.,LTD  
Xiayang, Jizhao, Zhonggang village,  
Saiqi Economical & Development Zone,  
Fuan, Fujian, P.R.C.  
TEL: +86 593 633 0300  
FAX: +86 593 633 0303

## HONG KONG

Tecoson Industrail Development  
(HK) Co., Ltd  
Rm 3712 Hong Kong Plaza  
186-191 Connaught Rd. West  
Hong Kong  
Tel: +852 2858 3220  
E-mail: techhkg@netvigator.com

## MALAYSIA

Plo 52, Jalan Firma 2/1,  
Kawasan Perindustrian Tebrau 1,  
81100 Johor Bahru, Johor, Malaysia  
Tel: (60) 7-3518862 / (60) 7-3548008  
Fax: (60) 7-3546107  
E-mail: sales@teco.com.my

## THAILAND

Teco Electric & Machinery  
(Thai) Co., Ltd.  
128/1 Soi Watsrivareenoi  
Moo 7 Bangna-Trad Road Km 18  
Bangchalong Bangplee  
Samuthprakarn 10540 Thailand  
Tel: +662-3371311-20  
Fax: +662-337-1630-1

## VIETNAM

Teco (Vietnam) Electric & Machinery Co.,Ltd.  
KON LONG Thanh,Huyen Long Thanh  
Tinh Dong Nai. Vietnam  
Tel: +84 61 3514151  
Fax: +84 61 351 4110

## PHILIPPINES

Trade One, Incorporated  
No. 56 Aragon Street San Francisco  
Del Monte 1100 Quezon City Metro Manila,  
Philippines  
Tel: (632) 371-3032  
Fax: (632) 371-1175  
www.tradeoneinc.com